

Traveling in an RV: Is it right for you?

The basics for living in an RV full-time



Conflict of Interest

DISCLOSURE: No planner, presenter, faculty, author, or content expert has identified a conflict of interest that would affect this educational activity

No commercial interest has provided financial or in-kind support for this educational activity

TravCon does not endorse any commercial products discussed or displayed in conjunction with this educational activity

Objectives

1. Review the different types of RV's and pros/cons of each
2. Discuss towing, weight, parking, and safety considerations
3. Compare traditional housing costs vs RV costs
4. Provide tips & tricks for finding housing

Outcomes

1. List the different types of RV options available to you
2. Understand the pros and cons of different RV classes
3. Describe different methods for finding RV “housing”
4. Understand the importance of weight considerations for safe towing/parking

About the Speakers

Thomas Gilhooly

- Spouse of healthcare traveler
- Full time in 5th wheel for 7 years
- Support team, RV & truck maintenance
- Camp Host for private & State Parks
- 1st 5th wheel purchase 2004
- 2nd purchase (toy hauler) 2009



About the Speakers

Shannon Herold, PT, DPT

- PT for 5.5 years
- Travel PT for 4.5 years
- Solo traveler + cat
- 1st RV purchase July 2020
- 2nd RV purchase February 2022
- Class C motorhome
- Flat tow Subaru Crosstrek



Let's get to know each other...

1. Who currently lives in an RV?
2. Who travels with a partner?
3. Who travels alone?
4. Who is new to RV living?

Which RV should I choose?

RV Classes: Class A

Length: 26 to 45 ft

Weight: 13,000 to 30,000 lbs

Capacity: 1-4 people

Pros: more luxurious, true home on wheels, more space/amenities

Cons: more expensive to buy/maintain, parking limitations, special license

Avg cost: \$100K - \$300K+



RV Classes: Class B

Length: 17 to 23 ft

Weight: 4,000 to 9,000 lbs

Capacity: 1-2 people

Pros: more travel freedom, easy parking, more fuel efficient

Cons: less storage, small living space, fewer amenities

Avg cost: \$80K - \$180K

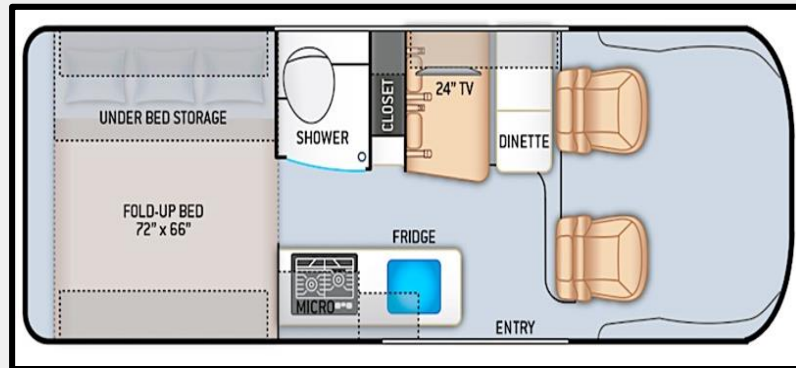

RV Classes: Class C

Length: 20 to 30 ft

Weight: 10,000 to 13,000 lbs

Capacity: 1-4 people

Pros: less expensive, easy to maneuver, standard amenities, space over cab

Cons: less space than Class A, still costly to maintain, possible size limitations

Avg cost: \$50K - \$150K

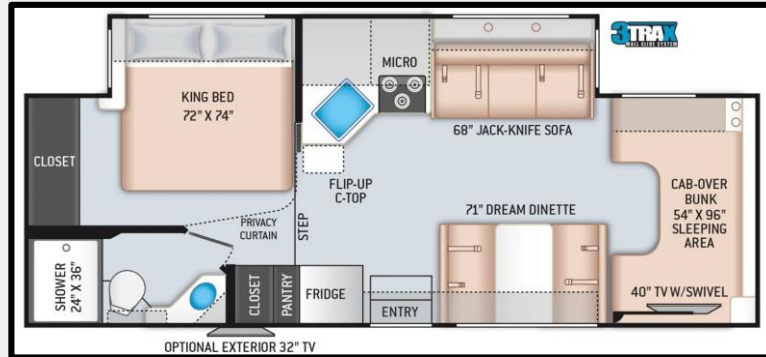

RV Classes: Travel Trailer

Length: 10 to 40 ft

Weight: 1,100 to 12,000 lbs

Capacity: 1-6 people

Pros: unhitch & leave, more affordable, no engine maintenance

Cons: more difficult to reverse/park, unstable high winds, weight distribution

Avg cost: \$10K - \$100K

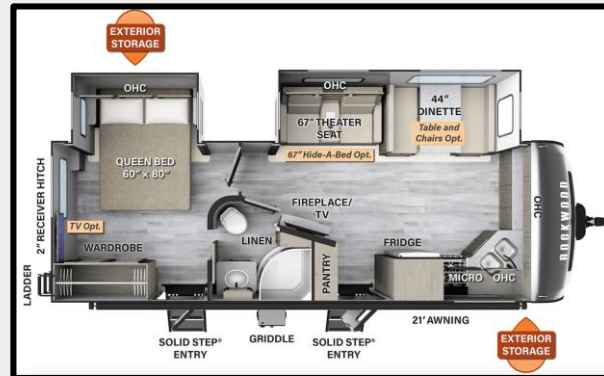

RV Classes: Fifth Wheel

Length: 22 to 40 ft

Weight: 7,000 to 20,000 lbs

Capacity: 1-6 people

Pros: most stable towable RV, most storage space, multiple bedrooms

Cons: vehicle limitations, length/height restrictions, less fuel efficient (weight)

Avg cost: \$35K - \$150K



RV Option: Toy Hauler



RV Classes: Pop Up Trailer

Length: 8 to 16 ft

Weight: 700 to 4,000 lbs

Capacity: 1-2 people

Pros: lightweight, easy towing/storage, very affordable

Cons: no insulation, less storage/amenities, lower cargo capacity

Avg cost: \$2K - \$20K

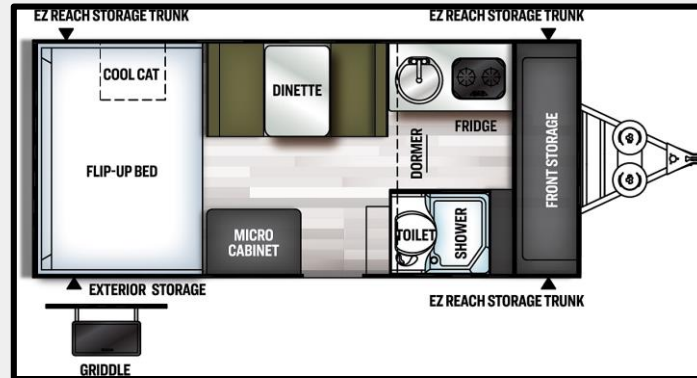

RV Classes: Camper Truck

Length: a few ft longer than truck

Avg cost: \$5K - \$60K

Weight: 1,000 to 3,600 lbs Unloaded Vehicle Weight (UVW)

Capacity: 1-2 people

Pros: "off the grid" travel, 4WD + powerful suspension, easy parking

Cons: limited storage/amenities, not compatible for families

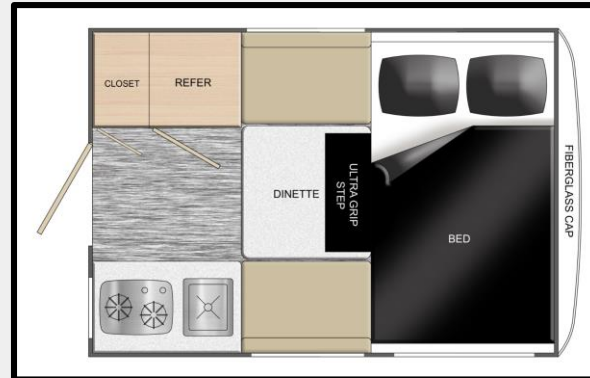

RV Classes: Bus Conversion

Length: variable

Weight: variable

Capacity: 1-6 people

Pros: customized to your needs, can be cheaper DIY, typically larger

Cons: campground limitations, mechanic limitations, time consuming

Avg cost: \$10K - \$70K



RV Features: Slides vs No Slides

Pros: more space, adds windows, unit size considerations

Cons: mechanical issues, more weight, balance considerations



RV Features: Slides vs No Slides

Slide In



Slide Out



RV Features: Length Considerations

Pros: more space and amenities

Cons: driving/parking difficulties, park entry limitations



Is an RV more cost effective?

Cost Considerations

Type of RV

- Varies based on manufacturer, year, model, length, overall condition
- What are the current market trends

Loan payment, interest rates, and insurance

- Longer loan / higher down payment = lower monthly payment / interest rate
- Current interest market: 7-8%

Rent

- Campground/parking fees
- Utilities

Cost Considerations

Maintenance

- Warranty coverage?

Vehicle

- Truck for travel trailer
- Towable vehicles
 - Manual transmission or transfer case
 - Jeep Wrangler (1997-2023)
 - Chevrolet Equinox (2010-2023)
 - Honda CRV (2007-2014)



Extra Costs

Flat tow package (\$4000+)

Towing dollies (\$500 - \$1000)

Brake control (\$200)

Flatbed trailers (\$4000+)

Sewage hoses (\$40 - \$50)

Pressure regulator (\$10 - \$20)

Extra storage (\$2000)

Wifi or cell signal booster (\$500)

Bicycle or kayak rack (~\$100)

Ladder (~\$200)



Winter Living

Heated underbelly

Furnace or electric add on

Heat tape for water line

Electric heater must not exceed line input

Dehumidifier

Moisture builds up under mattress

Sleep with window open

Water pump - is it safe from cold air?

***AVOID IF YOU CAN**



Towing, Weight, Parking, & Safety

Towing: Weight Considerations

DRY WEIGHT: 12728 LBS
RECREATIONAL VEHICLE OVERALL
LENGTH 41'3" AS MANUFACTURED.

TIRE AND LOADING INFORMATION

The combined weight of cargo should never exceed
1276 kg or 2814 lbs.

TIRE	SIZE	COLD TIRE PRESSURE	SEE OWNER'S MANUAL FOR ADDITIONAL INFORMATION
FRONT	ST255/85R16/E	80 PSI / 552 KPA	
REAR	ST255/85R16/E	80 PSI / 552 KPA	
SPARE	ST255/85R16/E	80 PSI / 552 KPA	

T
D
9
0
1
2
3
0
5

RENSEIGNEMENTS SUR LE

Le poids du chargement
1276 kg ou 2814 lb.

PNEU	DIMENSIONS	PRESSION
AVANT	ST255/85R16/E	80 LB/
ARRIÈRE	ST255/85R16/E	80 LB/
DE SECOURS	ST255/85R16/E	80 LB/

MANUFACTURED BY / FABRIQUÉ PAR: FOREST RIVER, INC. DATE: 05/08/2023 TDF386MBOK
GVWR/PNBV: 7355 KG (16215 LB)
GAWR(EACH AXLE) /PNBE(CHAUQUE ESSIEU): 3175 KG (7000 LB)
TIRES/PNEU: ST255/85R16/E RIMS/JANTE: 16X7.0J
COLD INFL. PRESS./PRESS. DE GONFL. À FROID: 552 KPA (80 PS/LPC)

Label on side of 5th wheel

Towing: Weight Considerations

DATE: 7/19/2022

MANUFACTURED BY/FABRIQUÉ PAR: KEYSTONE RV COMPANY
2642 HACKBERRY DRIVE
GOSHEN, IN 46526

V.I.N./N.I.V.: 4YDTBLH14PT430254 TYPE: TRA/REM MODEL: BL1850RB2

UNLOADED VEHICLE WEIGHT _____ 1923 KG / 4240 LB
GVWR / PNBV _____ 2132 KG / 4700 LB
GAWR (EACH AXLE)/PNBE(CHAQUE ESSIEU) _____ 1996 KG / 4400 LB
TIRE / PNEU _____ ST225/75R15D
RIMS/JANTE _____ 15x6
COLD INFL. PRESS/PRESS. DE GONFL. À FROID _____ 448 KPA / 65 PSI/LPC - SINGLE

THIS VEHICLE CONFORMS TO ALL APPLICABLE STANDARDS PRESCRIBED UNDER THE CANADIAN MOTOR VEHICLE SAFETY REGULATIONS IN EFFECT ON THE DATE OF MANUFACTURE / CE VÉHICULE EST CONFORME À TOUTES LES NORMES QUI LUI SONT APPLICABLES EN VERTU DU RÉGLEMENT SUR LA SÉCURITÉ DES VÉHICULES AUTOMOBILES DU CANADA EN VIGUEUR À LA DATE DE SA FABRICATION.

ALL WEIGHTS ARE APPROXIMATE

113 lb

CARGO-CARRYING CAPACITY 51 KG / 113 LB CAPACITÉ DE CHARGE: 51 KG / 113 LB
CALCULATED WITH THE PROPANE, FRESH WATER, AND HOT WATER TANKS FULL, WASTE TANKS EMPTY. CALCULÉ AVEC LE PROPANE, L'EAU DOUCE, ET LES RÉSERVOIRS D'EAU CHAUDE PLEINS, ET LES RÉSERVOIRS DE DÉCHETS VIDES.
CAPACITIES: CAPACITÉS:

COLD: 139 KG	HOT: 0 KG	FROID: 139 KG	CHAUD: 0 KG
COLD: 307 LB	HOT: 0 LB	FROID: 307 LB	CHAUD: 0 LB

MASS OF WASTE WATER TANKS FULL: 226 KG / 498 LB
MASSE DES RÉSERVOIRS D'EAUX USÉES PLEINS: 226 KG / 498 LB



Label on side, or on hitch

Parking your RV



Safety Considerations

Brake controller for 5th wheel or travel trailer

Pressure regulator on water line

New tires - check date code before buying any RV

RV tire treads rarely wear out before they should be replaced (6-10 years)

Pay attention to vehicle height clearance

UV damage to roof and tires

Awareness of theft (bicycles)



Adaptor Cables - Use Safely



How to find housing

Housing Limitations

Weighing your options:

Housing or contract 1st?

Location may take priority

Big city vs rural town

West coast vs East coast

National / State Parks

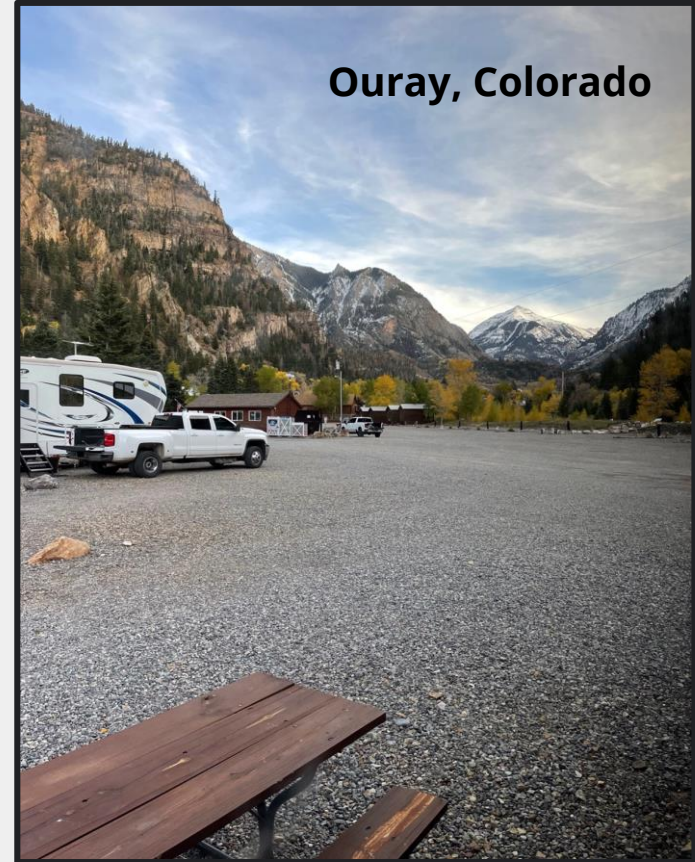

Campgrounds

Long term stay rates

Discounted / seasonal rates

Extra spots for travel nurses

Other campgrounds not found
on internet search



Campgrounds - Example

Oceanside, California

Paradise by the Sea

Stellar location for contract

Beside train tracks

Major ant problems (for us)

Monthly rate \$1750 - \$2500 + electricity



Campgrounds - Example

Death Valley

Remote camping in comfort

Very affordable accomodation
between contracts

Boondocking on BLM land
possible



Alternative Options

Staying on private / personal property

Facebook Groups

Furnished Finder

Craigslist Search

Boondocking

Be sure to ask about hook ups, amenities, extra costs, etc.



Final Thoughts

Extra Considerations

Traveling with pets

Traveling between contracts

Are you keeping a home?

- Cost to store RV
- Tax considerations for full timers with no "home"
- Tax home vs tax residency - see tax professional



Resources - Links in the TravCon App

RV Class Comparisons:

[Tiny Trailers to Huge RVs, a Definitive Guide](#) | Curbed.com

[RV Classes: Types of Motorhomes and Towable Trailers](#) | RVshare

[The Pros and Cons of RV Class Types - Drivin' & Vibin'](#)

Flat Towing:

[Best Vehicles to Flat Tow Behind an RV](#) | etrailer.com

Resources - Links in the TravCon App

Clubs

[Escapes RV Club](#)

[RV Online Community | Good Sam Club](#)

[Family Motor Coach Association](#)

Independent sites

[RV Driver's License Requirements In Every State | Campanda Magazine](#)

[Simple Guide to RV Driver's Licenses by State \[2023\] | rvezy.com](#)

[Renter Assistance Guide | Cruise America](#)

[RV Weight: The Most Important Question New RVers Don't Ask - Mortons on the Move](#)

[Vehicle Weight Ratings: What You Need to Know | RV LIFE Maintenance](#)

Resources - Links in the TravCon App

Government Sites

[License Classes and Requirements - California DMV](#)

[Driver's Licenses for Full Time Travelers | South Dakota DPS](#)

[Commercial Motor Vehicle Groups | South Dakota DPS](#)

[Classes of Driver Licenses | Texas Department of Public Safety](#)

Questions

